

BENEFITS

Highest Efficiency

SunPower™ Solar Panels are the most efficient photovoltaic panels on the market today.

More Power

Our panels produce more power in the same amount of space—up to 50% more than conventional designs and 100% more than thin film solar panels.

Reduced Installation Cost

More power per panel means fewer panels per install. This saves both time and money.

Reliable and Robust Design

Proven materials, tempered front glass, and a sturdy anodized frame allow panel to operate reliably in multiple mounting configurations.



SPR-425E-WHT-D



A new standard for power plants.

The SunPower® 425 Solar Panel provides today's highest efficiency and performance. Utilizing 128 back-contact solar cells, the SunPower 425 delivers a total panel conversion efficiency of 19.7%. The panel's reduced voltage-temperature coefficient, anti-reflective glass and exceptional low-light performance attributes provide outstanding energy delivery per peak power watt.

SunPower's High Efficiency Advantage

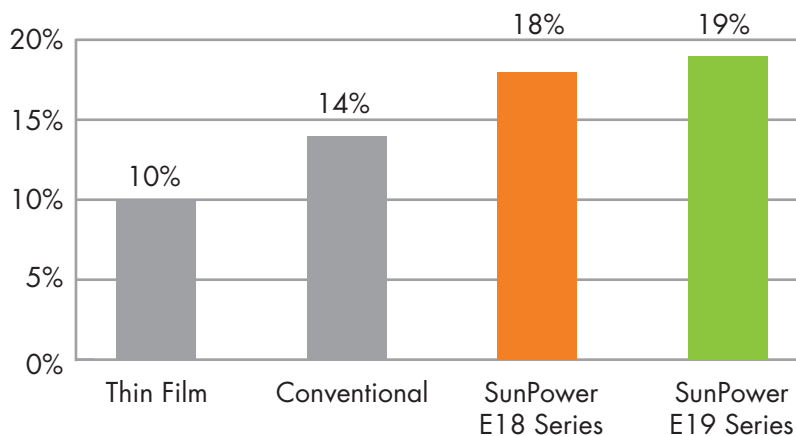

Electrical Data

Measured at Standard Test Conditions (STC): irradiance of 1000W/m², AM 1.5, and cell temperature 25° C

| | | |
|--------------------------|----------------------------|---------------|
| Peak Power (+/-5%) | P _{max} | 425 W |
| Efficiency | η | 19.7 % |
| Rated Voltage | V _{mpp} | 72.9 V |
| Rated Current | I _{mpp} | 5.83 A |
| Open Circuit Voltage | V _{oc} | 85.6 V |
| Short Circuit Current | I _{sc} | 6.18 A |
| Maximum System Voltage | UL | 600 V |
| Temperature Coefficients | Power (P) | -0.38% / K |
| | Voltage (V _{oc}) | -235.5mV / K |
| | Current (I _{sc}) | 3.5mA / K |
| NOCT | | 45° C +/-2° C |
| Series Fuse Rating | | 20 A |

Mechanical Data

| | |
|---------------|---|
| Solar Cells | 128 SunPower all-back contact monocrystalline |
| Front Glass | High transmission tempered glass with anti-reflective (AR) coating |
| Junction Box | IP-65 rated with 3 bypass diodes Dimensions: 32 x 155 x 128 (mm) |
| Output Cables | 1000 mm length cables/ MultiContact (MC4) connectors |
| Frame | Anodized aluminum alloy type 6063 (silver); stacking pins |
| Weight | 56.0 lbs. (25.4 kg) |

I-V Curve

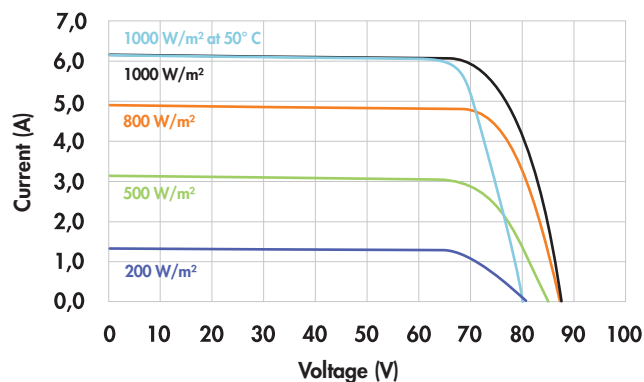

Current/voltage characteristics with dependence on irradiance and module temperature.

Tested Operating Conditions

| | |
|-------------------|--|
| Temperature | -40° F to +185° F (-40° C to + 85° C) |
| Max load | 50 psf (245 kg/m ²) (2400 Pa) front and back – e.g. wind |
| Impact Resistance | Hail 1 in (25 mm) at 52mph (23 m/s) |

Warranties and Certifications

| | |
|----------------|--|
| Warranties | 25 year limited power warranty |
| | 10 year limited product warranty |
| Certifications | Tested to UL 1703. Class C Fire Rating |

Dimensions

- Grounding Holes
- ⊙ Stacking Pins

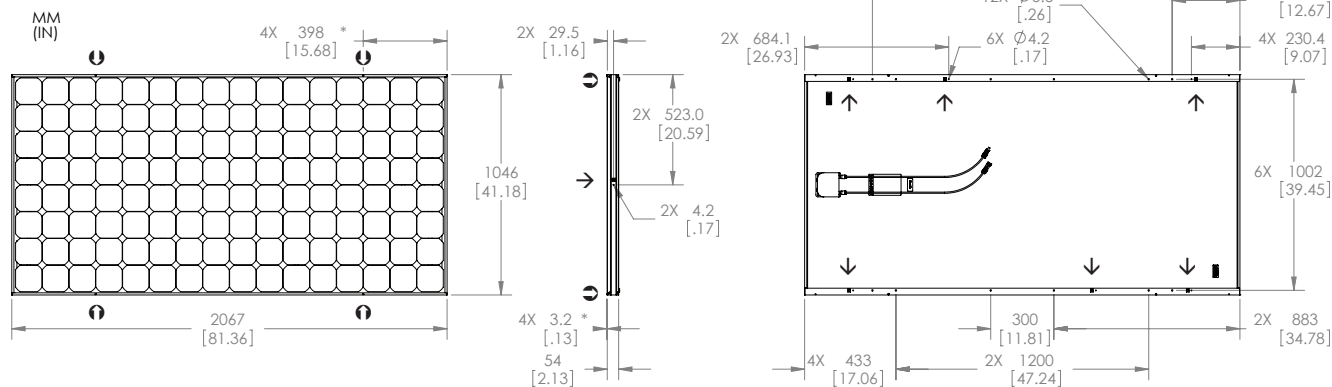

CAUTION: READ SAFETY AND INSTALLATION INSTRUCTIONS BEFORE USING THE PRODUCT.

Visit sunpowercorp.com for details